

FEATURE RECORD

F.S.U. St. Augustine Program

Site No. SA 34-2Date 4-23-80Sheet 1 of 1Feature No.: 2 Recorder R. COCHRANEExcavation Units: SA 34-2 TRENCH D SECTION 1Depth from Surface: CA. 8 cmDepth from Datum: Top: 1.58
Base: 1.71

Definition: FEATURE TWO IS ~~ROUGHLY~~ ADJACENT AND
ROUGHLY PARALLEL TO THE WEST KITCHEN WALL. IT IS
COMPOSED OF DARK GREY BROWN SANDY SOIL WITH
CRUSHED SHELL INCLUSIONS. ~~IT UNDERLIES~~

Matrix and Stratigraphy: _____

Underlies: ZONE 1 LEVEL 1In Matrix of: ZONE 1

Intrudes into: _____

Overlies: FEATURE 31. F.S. No's: 136 4. Photographs: none2. Map Reference: 2 5. Strat. Record Reference: 1163. Pages in Notes: 9, 10, 11, 12, 22Comments: FEW ARTIFACTS

SKETCH

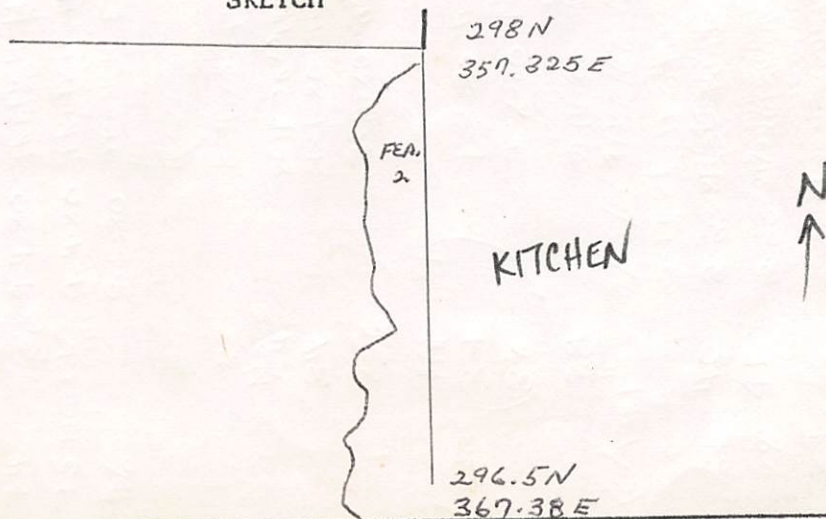

FEATURE RECORD

F.S.U. St. Augustine Program

Site No. SA 34-2Date 4-28-80Sheet 1 of 1Feature No.: 3Recorder Judy Hedemich

Excavation Units:

Zone 3 Level 1Depth from Surface: 23.5 cmDepth from Datum: Top: 1.71Base: 1.95Definition: Dark grey brown sandy soil w/ large mortar & plaster chunks
& 1 large brick chunk. Much large plaster chunks.

Matrix and Stratigraphy:

Underlies: @ Feature 2In Matrix of: Zone 3 Level 1

Intrudes into:

Overlies: Area 171. F.S. No's: 1524. Photographs: 242. Map Reference: Map #45. Strat. Record Reference: 1163. Pages in Notes: 21-23; 49Comments: ALTHO THIS UNDERLIES FEATURE 2, WHICH BOTTOMED OUT AT 1.71, IT
WAS AN UNEVEN SURFACE.

SKETCH



KITCHEN

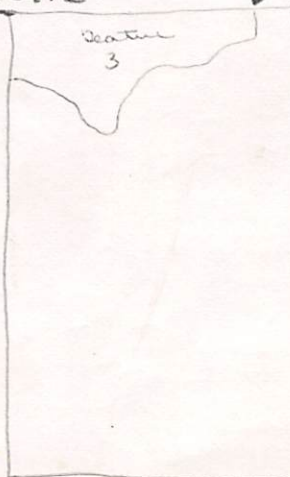

here there is a break in the west Kitchen foundation. Top of break at 1.65 MBD. Coinciding w/ the break in the wall foundation Feat 3 begins. Clearly has something to do with break in the wall.

FEATURE RECORD

F.S.U. St. Augustine Program

Site No. 34-2Date 5-7-80Sheet 1 of 1Feature No.: 4Recorder B.J. Taylor KingExcavation Units: TRENCH D SECTION I

Depth from Surface: _____

Depth from Datum: Top: 1.89
Base: 2.17

Definition: medium grey-brown sandy soil with slight grey sandy soil mottling, charcoal flecking, whole clam and oyster shell. Shell flecking. More whole shell in Level 1 than level 2.

Matrix and Stratigraphy: _____

Underlies: Zone 3 Level 2In Matrix of: Zone 3 Level 2Intrudes into: Area 15 and Area 17Overlies: Area 15 and Area 171. F.S. No's: 153, 1604. Photographs: 262. Map Reference: 7 6

5. Strat. Record Reference: _____

3. Pages in Notes: 47-48; 50; 52

Comments: It was not possible to level the pit without destroying a significant amount of Feature 4. Apparently the zone has been excavated too deep in one area, not allowing for the possibility of discovering a feature near the top of the level. Feat. 4 will be excavated in levels, + level one consisted of that portion →

SKETCH

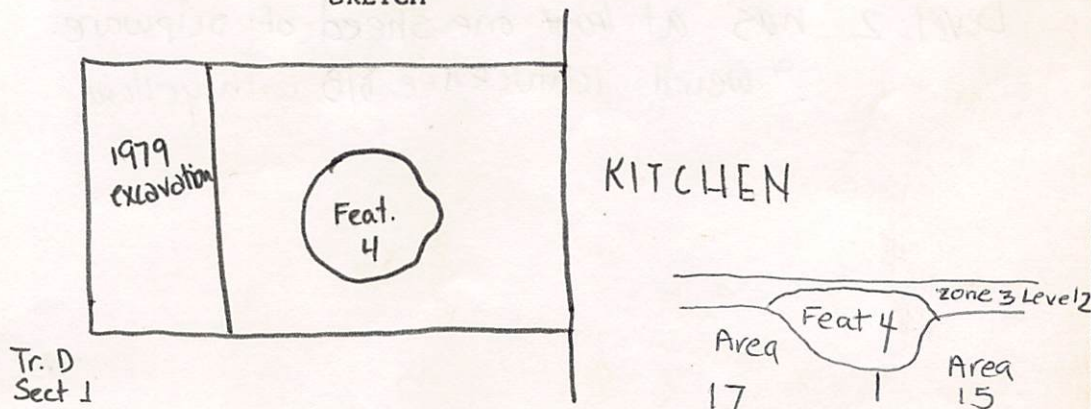

needed to bring the feature down to level in order to map.
BAD

Level 1 seems to have pearlware, British.

Level 2 has at least one sherd of slipware.

* weird Ichtucknee B/B with yellow

FEATURE RECORD

F.S.U. St. Augustine Program

Site No. SA 34-2Date 5-16-80Sheet 1 of 1Feature No.: 5 Recorder J. HellmichExcavation Units: Trench D. Sect 1

Depth from Surface: _____

Depth from Datum: Top: 2.29
Base: East - 2.405
Center - 2.425 West - 2.395Definition: light brown soil with some yellow mottling, no char-
coal or shell flecking

Matrix and Stratigraphy:

Underlies: Area 25

In Matrix of: _____

Intrudes into: SterileOverlies: Sterile

- | | |
|---------------------------------|------------------------------------|
| 1. F.S. No's: <u>179</u> | 4. Photographs: <u>28 & 29</u> |
| 2. Map Reference: <u>10, 11</u> | 5. Strat. Record Reference: _____ |
| 3. Pages in Notes: <u>64</u> | |

Comments: Shallow
not very wall trenchy

SKETCH

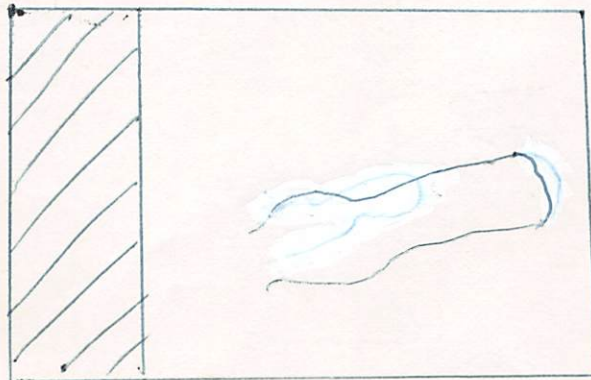

Kitchen

FEATURE RECORD

F.S.U. St. Augustine Program

Site No. SA 34-2Date July 21, 1980Sheet 1 of 1Feature No.: 6Recorder F. GaskeExcavation Units: Trench EDepth from Surface: 15 cmDepth from Datum: Top: 1.61
Base: 1.64Definition: Compact coquina interspersed with light brown/grey soil, large coquina chunks, bottle fragments, and oyster shell clumps

Matrix and Stratigraphy:

Underlies: 7 floor 1In Matrix of: Zone 1Intrudes into: 7 floor 3Overlies: 7 floor 3

1. F.S. No's: 201
2. Map Reference: 14
3. Pages in Notes: 6-7 (9), 8 (11), 12 (16)
4. Photographs: 34
5. Strat. Record Reference: 128

Comments: Feature 6 turned out to be 7 floor 3. The only material still designated Feature 6 (Level 1) is the light brown/grey sandy soil which lay on top of 7 floor 3.

SKETCH

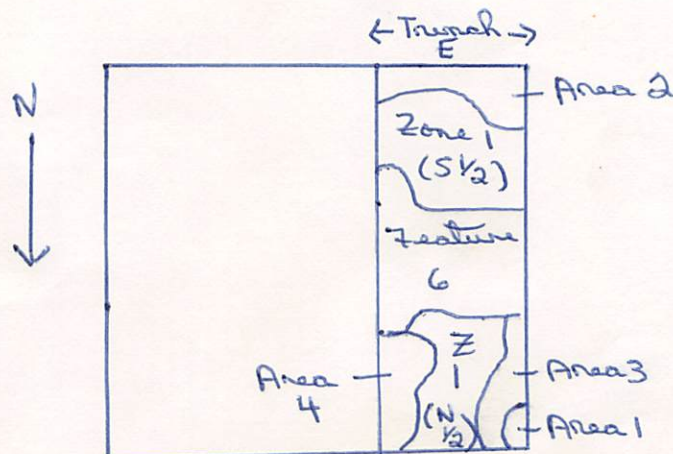

FEATURE RECORD

F.S.U. St. Augustine Program

Site No. SA 34-2

Date JULY 2, 1980

Sheet 1 of 1

Feature No.: 7 Recorder KING

Excavation Units: TRENCH D, SECTION 2

Depth from Surface: _____

Depth from Datum: Top: 1.71
Base: 1.90

Definition: Coquina wall footing - consisted of coquina block + decomposing coquina block, forming an apparent southwest corner of a building.
- rubble line for wooden bldg depicted in late 19th c. photo of Jarvis House kitchen

Matrix and Stratigraphy: _____

Underlies: _____

In Matrix of: Zone 2 Level 2 + Zone 3 Level 1

Intrudes into: _____

Overlies: Zone 3 Level 1

1. F.S. No's: 252
2. Map Reference: 16
3. Pages in Notes: 93, 99, 101, 124b
4. Photographs: # 36
5. Strat. Record Reference: _____

Comments: Feat 7 was excavated + the decomposing coquina screened, no cultural or faunal material. In the SE corner of the square, 2 clay areas, Areas 11 & 12 were present at a gap within the rubble line. These relatively thin lenses of clay (ca. 5 cm)

SKETCH

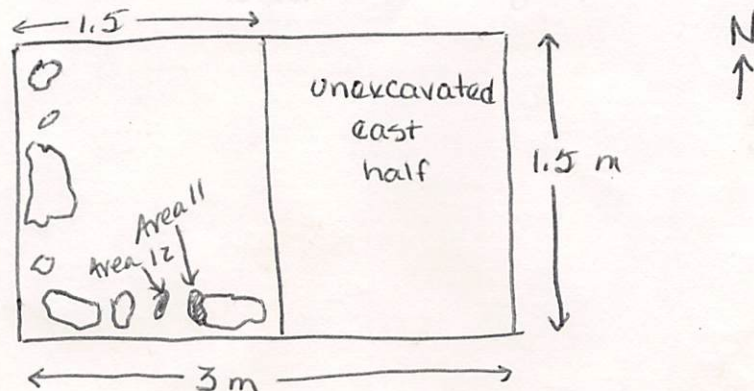

underlay the coquina blocks.

Area 11 FS# 200

page in notes - 97

Area 12 FS#

page in notes - 98, 101

FEATURE RECORD

F.S.U. St. Augustine Program

Site No. SA 34-2Date July 21, 1980Sheet 1 of 1Feature No.: 8 Recorder F. GarheExcavation Units: Trench EDepth from Surface: 44 ~~44~~ cm.Depth from Datum: Top: 2.05
Base: 2.10Definition: Light gray sandy soil with some brown mottling and charcoal flecking.

Matrix and Stratigraphy:

Underlies: Zone 3, Level 2In Matrix of: Zone 3, Level 3Intrudes into: Zone 4Overlies: Zone 4

1. F.S. No's: 237
2. Map Reference: 23
3. Pages in Notes: 26-27 (33), 28 (34)
4. Photographs: 41
5. Strat. Record Reference: 118 + 128 + 133

Comments: Quickly bottomed out - only 5 cm. thick.

SKETCH

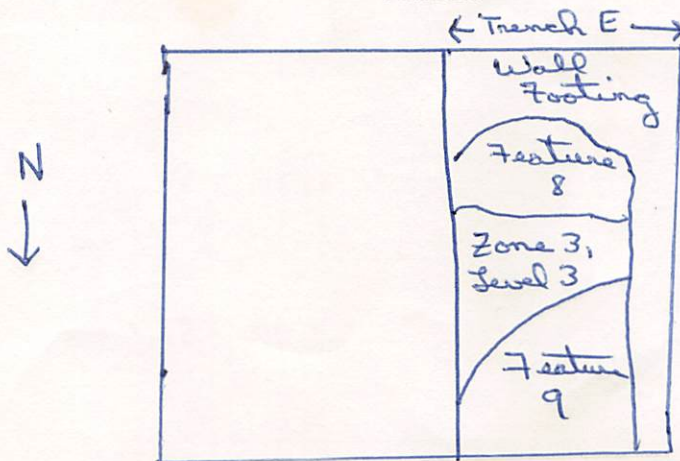

FEATURE RECORD

F.S.U. St. Augustine Program

Site No. SA 34-2Date July 21, 1980Sheet 1 of 1Feature No.: 9Recorder F. GarheExcavation Units: Trench EDepth from Surface: 44 cm.Depth from Datum: Top: 2.05
Base: 2.08Definition: Mottled brown, gold, and black sandy soil
Roughly semicircular in shape.

Matrix and Stratigraphy:

Underlies: Zone 3, Level 2In Matrix of: Zone 3, Level 3Intrudes into: Zone 4Overlies: Zone 41. F.S. No's: 2384. Photographs: 412. Map Reference: 235. Strat. Record Reference: 1283. Pages in Notes: 26-27(33), 28(34,35)Comments: Quickly bottomed out - Only 3 cm. deep

SKETCH

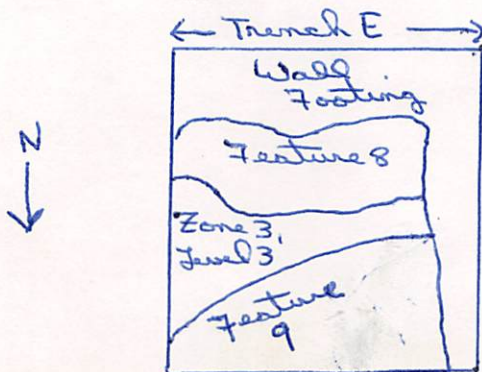

FEATURE RECORD

F.S.U. St. Augustine Program

Site No. SA 34-2

Date July 21, 1980

Sheet 1 of 1

Feature No.: 10 Recorder F. Gaske

Excavation Units: Trench E

Depth from Surface: 52 cm

Depth from Datum: Top: 2.13
Base: 2.23

Definition: Dark brown sandy soil. Roughly rectangular in shape, it runs along side the wall footing (Areas 10 & 11). It is intersected by Feature 11 with a N & S portions. The S 1/2 proved to be very shallow and its contents are combined with that of the N 1/2.

Matrix and Stratigraphy:

Underlies: Zone 4, Level 1

In Matrix of: Zone 4, Level 2

Intrudes into:

Overlies: Zone 4, Level 2

1. F.S. No's: 259
2. Map Reference: 24
3. Pages in Notes: 31 (38), 34 (43)
4. Photographs: 42
5. Strat. Record Reference: 118

Comments: Possible builder's trench.

SKETCH

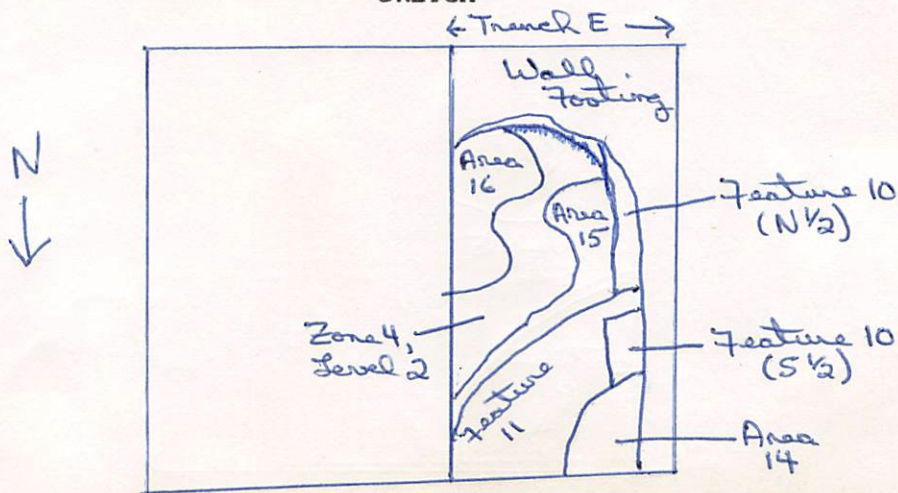

FEATURE RECORD

F.S.U. St. Augustine Program

Site No. SA 34-2Date July 21, 1980Sheet 1 of 1Feature No.: 11Recorder F. GarbeExcavation Units: Trench EDepth from Surface: 55 cmDepth from Datum: Top: 2.16*Base: 2.25

Definition: Brown and gold mottled sandy soil. Roughly semicircular in shape and encircles Area 14. It will be excavated in arbitrary levels.

*Only one level was excavated. Not fully excavated due to lack of time.

Matrix and Stratigraphy:

Underlies: Zone 4, Level 1In Matrix of: Zone 4, Level 2

Intrudes into:

Overlies: Not fully excavated1. F.S. No's: 260,4. Photographs: 422. Map Reference: 245. Strat. Record Reference: 118+1283. Pages in Notes: 31 (38)Comments: May in actuality be an extension of Feature 9.

8 cm. between Features 9 + 11 were excavated as Zone 4, Level 1. Possible construction pit.

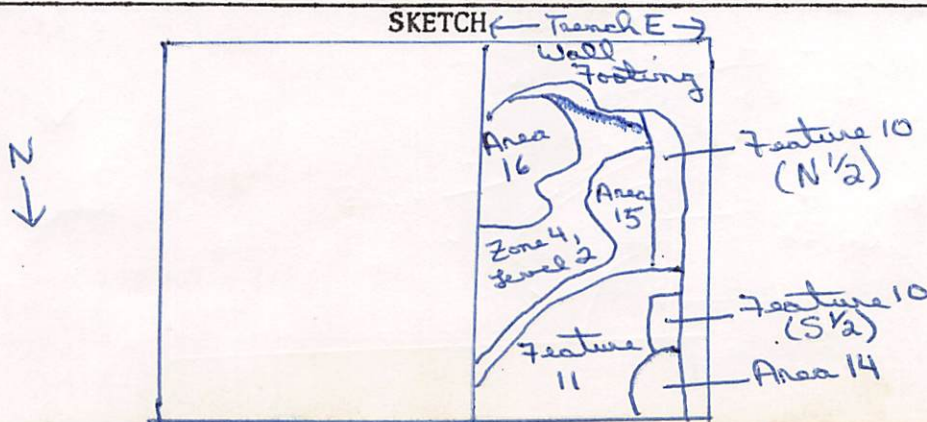

FEATURE RECORD

F.S.U. St. Augustine Program

Site No. SA 34-2 1980

Date JULY 18, 1980

Sheet 1 of

Feature No.: 12

Recorder KING

Excavation Units: TRENCH D; SECTION 3

Depth from Surface:

Depth from Datum: Top: 1.89
Base: 2.01

Definition: consists of coquina blocks + rubble, medium grey, brown sandy soil; plaster + coquina chunks + bldg rubble, fairly compacted.

Resembles apparent door stoop

Matrix and Stratigraphy:

Underlies: Zone 3 Level 1

In Matrix of: Zone 3, Level 1 and Zone 3 Level 2

Intrudes into: —

Overlies: Zone 3 Level 2

1. F.S. No's: 275 (& 276)

4. Photographs: #43

2. Map Reference: 22

5. Strat. Record Reference:

3. Pages in Notes: 123, 124, 130-132

Comments: Surrounding soil matrix of Feat 12 screened + saved: FS 276

Door stoop (w/ wooden bldg) pictured in late 19th c. photo of Fatio House (kitchen)? Photo in possession of historical architect Chas. Phillips, from Thurston - Salem, N.C.

Trench D -

SKETCH

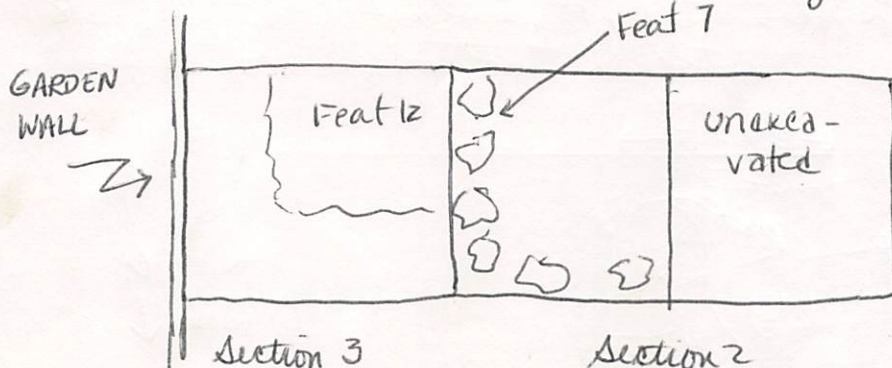

FEATURE RECORD

F.S.U. St. Augustine Program

Site No. SA 34-2

Date July 25, 1980

Sheet 1 of 1

Feature No.: 13

Recorder F. Gaske

Excavation Units: Trench F

Depth from Surface: 32 cm.

Depth from Datum: Top: 1.77

Base: 1.82

Definition: Consists of a sandy medium brown/grey sandy soil with shell flecking. Located north of Floor 4 - Possible earth floor.

Matrix and Stratigraphy:

Underlies: Zone 2

In Matrix of: Floor 4

Intrudes into: Zone 3, Level 1

Overlies: Zone 3, Level 1

1. F.S. No's: 272

4. Photographs: 46

2. Map Reference: 25

5. Strat. Record Reference: 124

3. Pages in Notes: 39(49), 40(51), 41(52)

+125

Comments:

SKETCH

N
↓

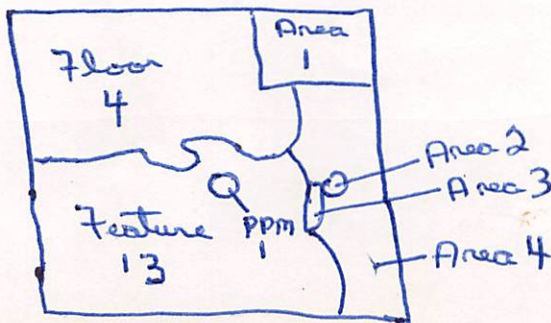

FEATURE RECORD

F.S.U. St. Augustine Program

Site No. SA 34-2
Date August 5, 1980
Sheet 1 of Feature No.: 14 Recorder King, JuliaExcavation Units: Trench D, Section 3Depth from Surface: Depth from Datum: Top: 2.12
Base: 2.26

Definition: Feature 14 is a trench-like feature running on a N-S axis in the west half of the pit. Feature 14 Level 1 consisted of extremely dry light grey sandy soil which was very compact. Feature 14 Level 2 consists of black + gold sandy soil, like zone 4 but much drier + compact.

Matrix and Stratigraphy:

Underlies: zone 3 Level 2In Matrix of: zone 4 Level 1

Intrudes into:

Overlies: Zone 4 Level 11. F.S. No's: 281, 3004. Photographs: PL#47 (2 B/Ws, 1 color)2. Map Reference: 285. Strat. Record Reference: 3. Pages in Notes: 134-139, 143

Comments: Feature 14, Level 1: T-2.12 B-2.19 Feature 14, Level 2: T-2.21 B-
DRY-COMPACT

SKETCH

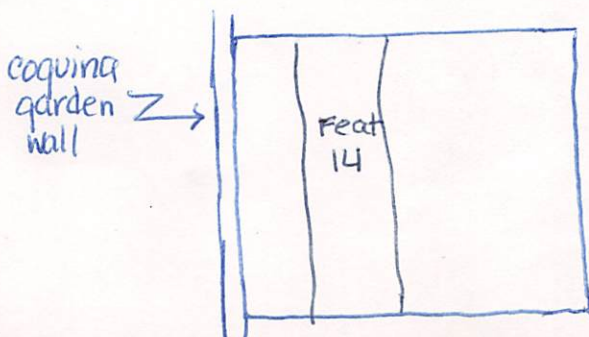

FEATURE RECORD

F.S.U. St. Augustine Program

Site No. SA 34-2Date July 29, 1980Sheet 1 of 1Feature No.: 15Recorder F. GaskeExcavation Units: Trench FDepth from Surface: 65 cm.Depth from Datum: Top: 2.10Base: 2.23

Definition: Dark brown sandy soil. Circular in shape.
Located at the north end of the trench. It contains
many large oyster shells.

Matrix and Stratigraphy:

Underlies: Zone 3, Level 3In Matrix of: Zone 4, Level 1Intrudes into: Zone 4, Level 2Overlies: Zone 4, Level 21. F.S. No's: 2904. Photographs: 482. Map Reference: 275. Strat. Record Reference: 1173. Pages in Notes: 43(56)124, + 125

Comments:

SKETCH

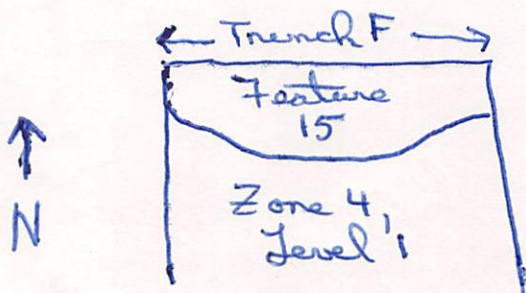

FEATURE RECORD

F.S.U. St. Augustine Program

Site No. SA 34-2Date 9-16-80Sheet 1 of 1Feature No.: 16Recorder F. GaskeExcavation Units: TRENCH HDepth from Surface: —Depth from Datum: Top: 1.45*Base: 2.29

*Not fully excavated

Definition: Very loose light brown/grey sandy soil with heavy shell flecking and large amounts of building rubble.
Excavated in arbitrary levels. At 1.82 MBD, it increased in size from its surface proportions. At 2.13 MBD, it began to recede to its former proportions.

Matrix and Stratigraphy:

Underlies: —In Matrix of: Floors 2+3, Zones 1-3Intrudes into: Floors 2+3, Zones 1-3Overlies: Not fully excavated1. F.S. No's: 349, 358, + 3644. Photographs: 75 + 832. Map Reference: 40, 41, 425. Strat. Record Reference: 1313. Pages in Notes: 64(84), 70(92-93)Comments: Not fully excavatedLevel 1: T-1.45, B-1.65, FS-349 ; Level 2: T-1.65, B-1.85, FS-358;Level 3: T-1.85, B-2.29, FS-364

SKETCH

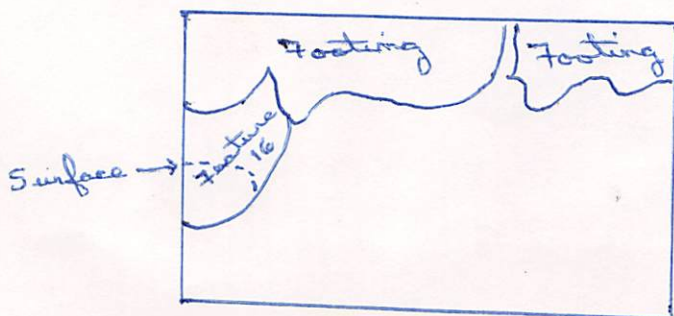

FEATURE RECORD

F.S.U. St. Augustine Program

Site No. SA 34-2Date 9-8-80Sheet 1 of 1Feature No.: 17Recorder F. GaskeExcavation Units: TRENCH HDepth from Surface: 8 cm.Depth from Datum: Top: 1.52
Base: 1.60Definition: Crumbley calcine with oyster shells and medium brown sandy soil.

Matrix and Stratigraphy:

Underlies: Floor 2In Matrix of: Zone 1Intrudes into: Zone 1Overlies: Zone 11. F.S. No's: 3484. Photographs: —2. Map Reference: 405. Strat. Record Reference: 130+1313. Pages in Notes: 65(86), 66(87)Comments: This feature also underlay Floor 2 in Trench E but was excavated with Floor 2.

SKETCH

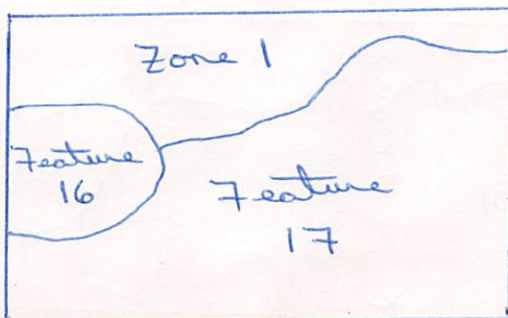

FEATURE RECORD

F.S.U. St. Augustine Program

Site No. 34-2Date 9-11-80Sheet 1 of 1Feature No.: 18 Recorder F. GaskeExcavation Units: TRENCH HDepth from Surface: 33 cm.Depth from Datum: Top: 1.80
Base: 2.07Definition: Compact black/dark brown sandy soil. It lies
directly under Floor 4. Excavated in arbitrary levels.

Matrix and Stratigraphy:

Underlies: Floor 4In Matrix of: Zone 3, Levels 2 + 3Intrudes into: Zone 3, Levels 2 + 3Overlies: Zone 41. F.S. No's: 356 + 359 4. Photographs: 792. Map Reference: 41 5. Strat. Record Reference: 1303. Pages in Notes: 69-70 (91-93)Comments: Excavated as Zone 3-B, Zone 3 - Lev 2 - N $\frac{1}{2}$, Zone 3 - Lev. 3
in Trench E.Level 1: T-1.80, B-2.00, FS-356; Level 2: T-2.00, B-2.07, FS-359.

SKETCH

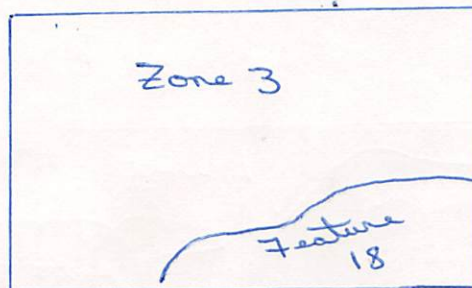
N
↓